

RINGSPANN-Flexible Couplings L

Connection Shaft – Shaft with Keyways

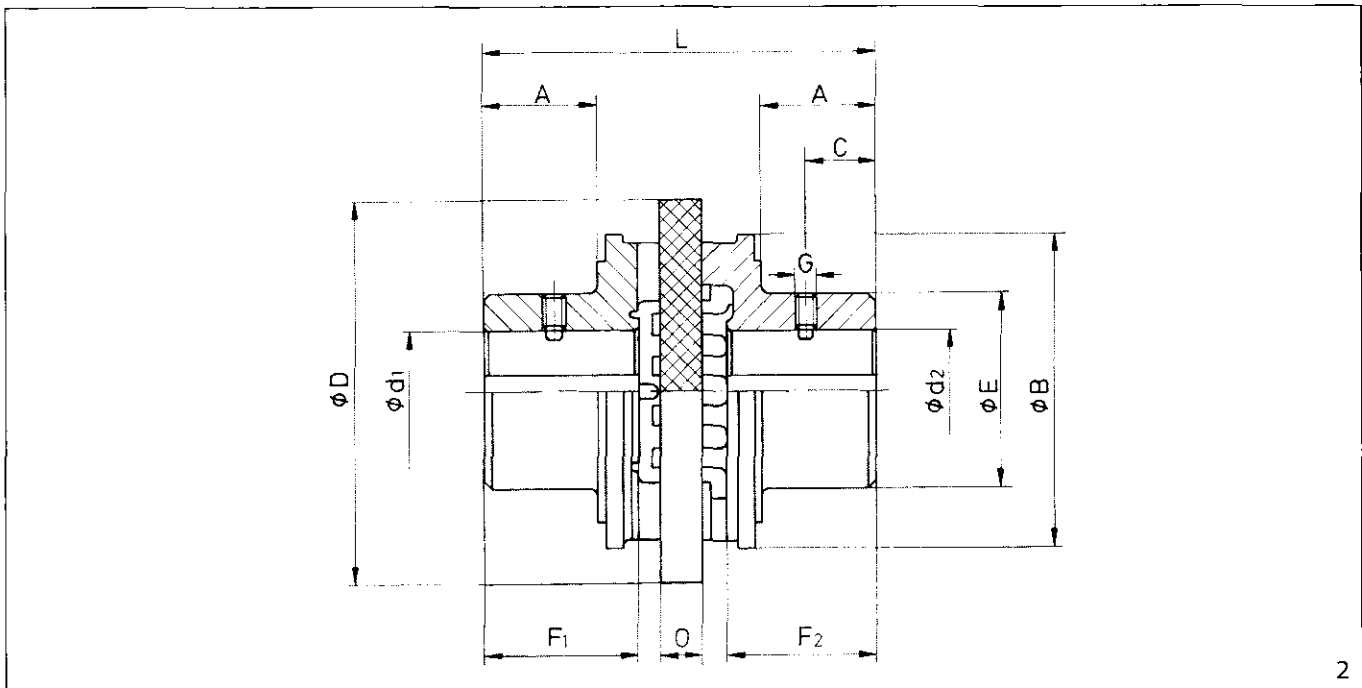

Technical Data and Dimensions

Type	Torque max. Nm	Speed max. 1/min	Parallel misalign- ment max. mm	Rough bore d mm	Finished bore d ₁ and d ₂		A mm	B mm	C mm	D mm	E mm	F ₁ */F ₂ *	G	L mm	O mm	Inertia J kgm ²	Weight with rough bore kg
					min. mm	max. mm											
L 10	2	13000	0,5	4,3	5	15	-	-	7	32	26	13	M4	35	6	0,0001	0,1
L 12	4	10500	0,6	5	6	18	-	-	10	40	32	16	M4	42	4	0,0002	0,2
L 16	8	8400	0,8	7	8	25	-	-	10,5	50	40	18,5	M5	51	6	0,0003	0,38
L 20	16	6800	1,0	9	10	30	-	-	17	63	50	25	M6	64	6	0,0004	0,78
L 27	32	5350	1,35	11	12	40	-	-	24	80	65	32	M6	85	8	0,0008	1,7
L 35	85	4100	1,75	15	16	35	33	90	25	110	53	42	M8	112	12	0,0013	1,9
L 42	190	3400	2,1	19	20	42	41	110	30	135	66	53	M8	136	14	0,0039	3,7
L 50	500	2670	2,5	29	30	50	51	135	40	160	85	62	M10	159	16	0,0097	6,3
L 70	1000	2140	3,5	33	34	70	65	163	45	200	104	79	M12	200	20	0,0268	12,1
L 90	2000	1700	4,5	48	50	90	81	202	60	250	150	100	M12	247	25	0,1110	28,9
L 110	4000	1350	5,5	58	60	110	101	254	70	315	175	124	M12	312	32	0,2911	50,9
L 140	8000	1050	7	72	75	140	130	330	90	400	216	160	M12	402	40	0,9767	104

* Hub lengths F₁ and F₂ can be shortened with corresponding changes to dimensions A, C and L.

Please specify when ordering

- Whether supply is required with rough bores as per catalogue or finished bore.
- If finished bore, give diameters d₁ and d₂. Tolerance of finished bores is H7. Keyways as per DIN 6885, p. 1 from finished bore size 6 mm.